



DISPLAY

Diagonal Size	70" 4K, 75" 4K, 86" 4K
Screen Type	TFT LCD (Direct LED Backlight)
Aspect Ratio	16:9
Display Area	70" 4K: 1541 x 868 mm (60.7 x 34.2 in) 75" 4K: 1652 x 930 mm (65 x 36.6 in) 86" 4K: 1895 x 1066 mm (74.6 x 41.9 in)
Display Colors	1.07 Billion
Resolution	4K UHD (3840 x 2160 @ 60 Hz)
Response Time	8 ms
Panel Refresh Rate	60 Hz
LED Lifespan	50,000 hours
LCD Viewing Angle	178°
Brightness	70" 4K: 370 cd/m2 75" 4K: 370 cd/m2 86" 4K: 400 cd/m2
Contrast Ratio	4000:1
Ambient Light Sensor	Yes
Glass Hardness	9H (pencil), 7 (Mohs)
Glass Type	Heat-tempered, Anti-Glare

INTERACTIVITY

Angled Center Console	Yes, with Power, Volume Control, Menu, Freeze, No Touch, Source Selection Buttons
Touch Technology	Vellum™ Writing Technology
Continuous Touch Points	20
Touch Resolution	32768 x 32768 px
Response Time	≤5 ms
Touch Accuracy	1 mm
Tracking Rate	6 m/s
Scan Rate	200 Hz
Gestures and Edge Swipes	Windows® Supported
Eraser Included (block eraser)	1
Pens Included	4 with Rear Erasing Feature
Pen Type	Battery-less Pen
Pen Holder	Integrated Full-length Pen Tray
Pen Tip Diameter	3 mm
Pen and Touch Differentiation	Yes
Pen Identities	2
Palm Detection	Yes
Annotation Over Any Source	Yes
Classroom Essential Apps	Including Whiteboard, Annotate, Timer, Spinner, Screen Capture, Screen Share, Browser, PDF Reader, Media Players
Compatibility	Windows® 8 to 10; OS X® 10.8 to 10.11 macOS® Sierra 10.12.1 or later; Linux® Ubuntu® 18.04 LTS; Chrome OS™

CONNECTIVITY

HDMI® 2.0 In (Rear)	1
HDMI 2.0 In (Front)	1
HDMI 2.0 Out	1
Display Port 1.2 In	1
VGA In	1
VGA Audio In	1
USB-A 2.0 (Rear)	2
USB-A 3.0 (faster data transfer, Rear)	1
USB-A 3.0 (faster data transfer, Front)	2
USB-B Touch (Rear)	2
USB-B Touch (Front)	1
USB-C (PD3.0/ USB3.0 inc Touch/ DP1.2, Rear)	1
LAN In (RJ45)	1x 10/100/1000 Mbps
LAN Out (RJ45)	1x 10/100/1000 Mbps
Wake-on-LAN	Yes
Wi-Fi® Module IEEE® 802.11a/b/g/n/ac Wireless, 2x2	Included
Bluetooth® 4.2	Yes
RS-232	Yes
CVBS	1
Mic In (3.5 mm)	1
Headphone	1
Proximity Sensor for Warm Boot	Yes
OPS Slot	1

COMPUTING

Operating System	Android™ Oreo 8
RAM	4 GB
Internal Storage	64 GB (32 GB x2)
CPU	Quad Core: (2) ARM Cortex A73, (2) ARM Cortex A53
GPU	ARM Mali-G51 MP4
Remote Over-the-Air Updates	Yes
Promethean Panel Management	Yes

AUDIO

Dual Front Facing, Bass Enhanced Speakers	70" 4K: 2 x15 Watts 75" 4K: 2 x15 Watts 86" 4K: 2 x 20 Watts
-------------------------------------------	--------------------------------------------------------------------

POWER

Power Requirements	100V - 240V AC
Power Consumption (Typical)	70" 4K: 115W 75" 4K: 124W 86" 4K: 195W
Power Consumption (Standby)	<=0.5 W
Ultra-Quiet Fanless Design	Yes

ENVIRONMENTAL

Operating Temperature	0°C to 40°C (32°F to 104°F)
Storage Temperature	-15°C to 55°C (-5°F to 131°F)
Operating Humidity	20% to 80% non-condensing humidity
Storage Humidity	20% to 90% non-condensing humidity

PHYSICAL SPECIFICATIONS

Panel Dimensions	70" 4K: 1668 x 1033 x 95 mm (65.7 x 40.7 x 3.7 in) 75" 4K: 1764 x 1089 x 109 mm (69.4 x 42.9 x 4.3 in) 86" 4K: 2014 x 1231 x 109 mm (79.3 x 48.5 x 4.3 in)
Packed Dimensions	70" 4K: 1796 x 1145 x 278 mm (70.7 x 45.1 x 11.0 in) 75" 4K: 1895 x 1200 x 278 mm (74.6 x 47.2 x 11.0 in) 86" 4K: 2140 x 1350 x 278 mm (84.3 x 53.1 x 11.0 in)
Net Weight	70" 4K: 53 kg (117 lbs) 75" 4K: 60 kg (132 lbs) 86" 4K: 75 kg (165 lbs)
Packed Weight	70" 4K: 75.5 kg (166.4 lbs) 75" 4K: 85.5 kg (188.5 lbs) 86" 4K: 101.6 kg (224.0 lbs)
Wall Mount Dimensions	1010 x 720 x 52 mm (39.8 x 28.3 x 2.0 in)
VESA Mount Point	70" 4K: 600 x 400 mm (23.6 x 15.7 in) 75" 4K: 800 x 400 mm (31.5 x 15.7 in) 86" 4K: 800 x 400 mm (31.5 x 15.7 in)

COMPLIANCE & CERTIFICATION

Regulatory Certifications	CE, FCC, IC, UL, CUL, CB, RCM
Energy Star Certified	70" 4K: Yes 75" 4K: Yes 86" 4K: Yes

EDUCATION SOFTWARE LICENSE

ActivInspire® Professional Single User	Included
----------------------------------------	----------

PACKED CONTENTS

What's in the Box	(1) ActivPanel Titanium (1) 3M Length HDMI Cable (1) 3M Length USB Cable (A-B) (1) 3M Regional Power Cable (1) 2M Length USB-C Cable (1) Remote Control (2) Batteries for Remote Control (4) ActivPanel Titanium Pens (1) Block Eraser (1) Sealed Antistatic Bag (4) VESA mount screws (M6) (1) Mini PC Bracket with screws (1) Quick Install Guide (1) Promethean Wi-Fi/Bluetooth Module (Ti) (2) Antenna (1) Promethean Wi-Fi/Bluetooth Module (Ti) User Guide (1) Wall Mount
-------------------	------------------------------------------------------------------------------------------------------------------------------------------------------------------------------------------------------------------------------------------------------------------------------------------------------------------------------------------------------------------------------------------------------------------------------------------------------------------------------------------------------------------------------------

INSTALLATION

The installation of this product should be completed by a qualified installer. Use of components not supplied by Promethean or not meeting minimum specifications may impact performance, safety and warranty. For more information, visit Support.PrometheanWorld.com.

WARRANTY

Warranty term and upgrade options vary by region. Contact your local reseller or distributor for information and visit PrometheanWorld.com/Warranty.

SUPPORT

For all Promethean products, visit Support.PrometheanWorld.com.

TECHNICAL DRAWINGS

70"

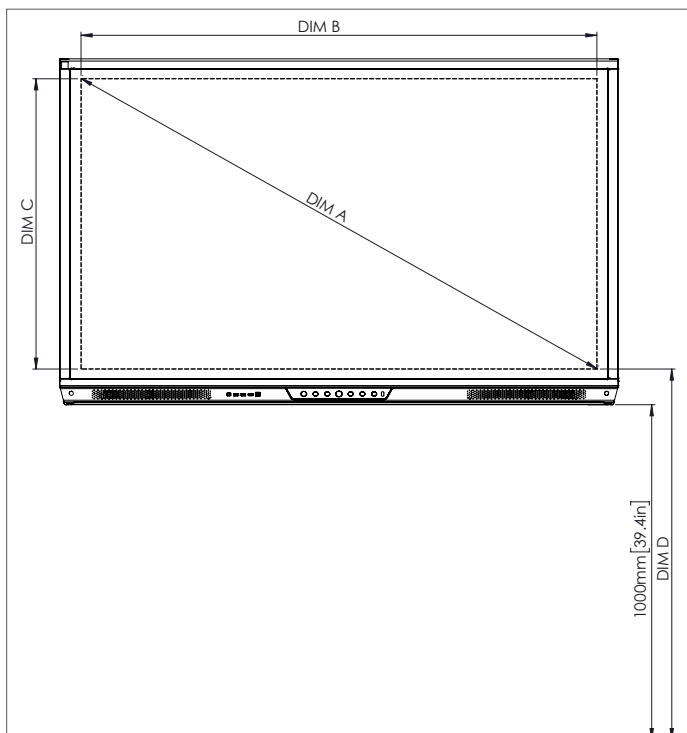

Front

DIM	DIMENSION (MM)	DIMENSION (IN)
A	1768	70.0
B	1541	60.7
C	867	34.1
D	1107	43.6
E	136	5.4
F	67	2.6
G	1033	40.7
H	1668	65.7
I	600	23.6
J Min	157	6.2
J Max	295	11.6
K Min	1157	45.6
K Max	1295	51.0
L	95	3.7

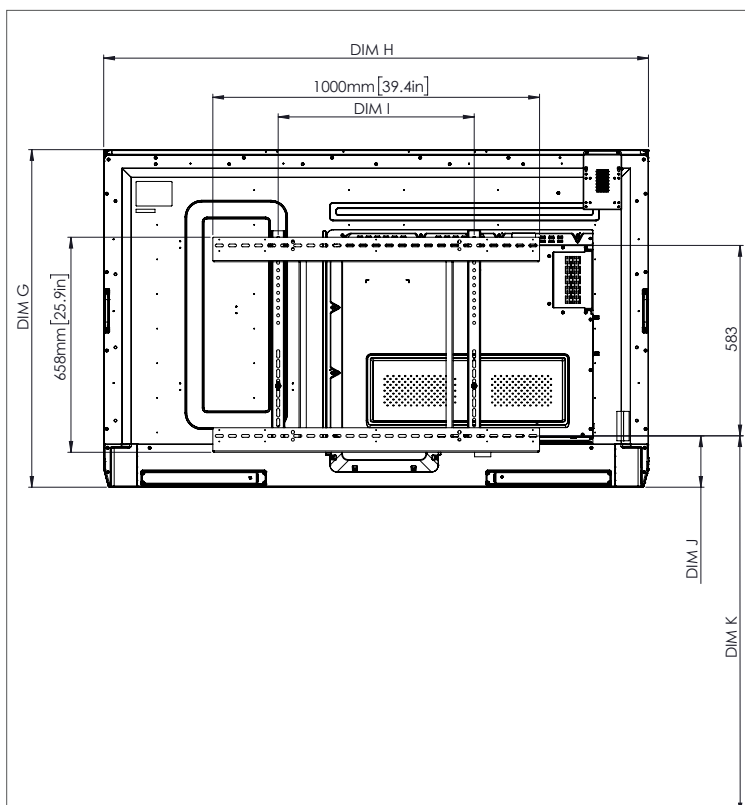

Back

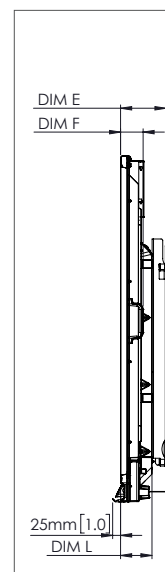

Side

ActivPanel 2019-E Titanium SS 05/21 v1.6a EN

Page 3

TECHNICAL DRAWINGS

75"

Front

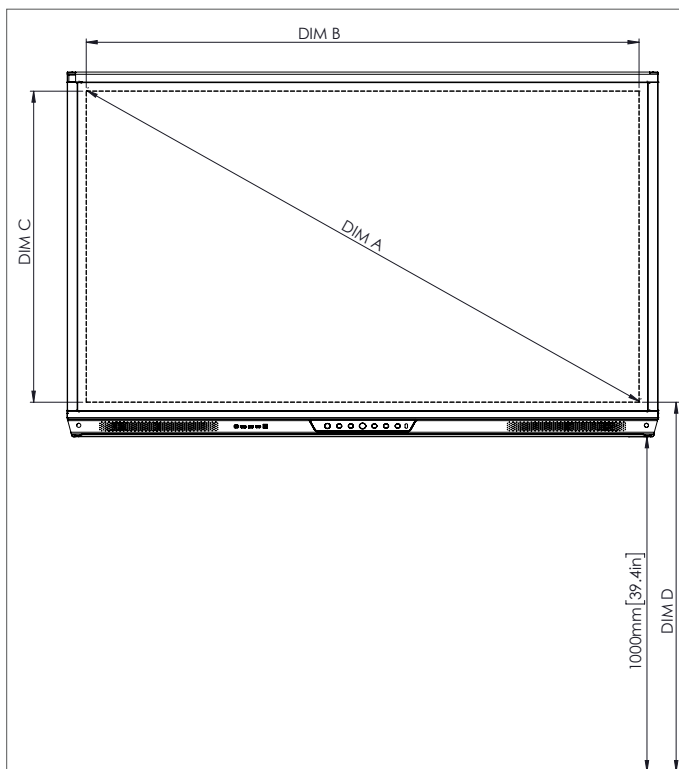

DIM	DIMENSION (MM)	DIMENSION (IN)
A	1894	75.6
B	1651	65.0
C	928	36.5
D	1103	43.4
E	133	5.2
F	67	2.6
G	1089	42.9
H	1764	69.4
I	800	31.5
J Min	214	8.4
J Max	352	13.9
K Min	1215	47.8
K Max	1353	53.3
L	109	4.3

Back

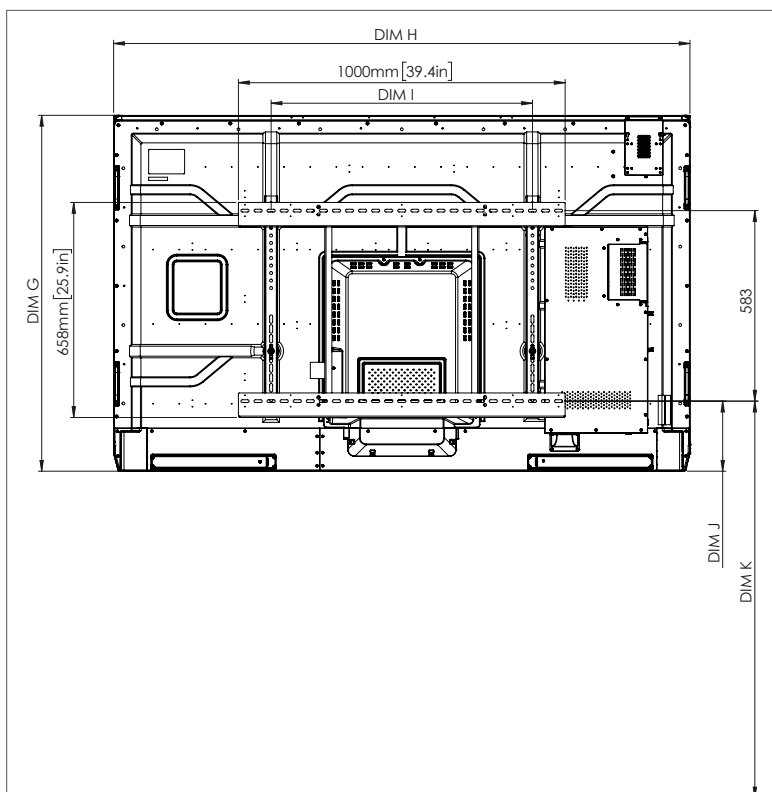

Side

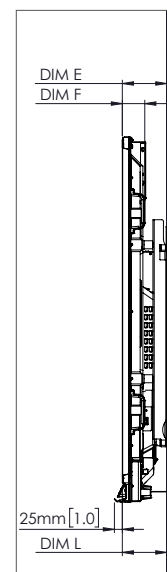

TECHNICAL DRAWINGS

86"

Front

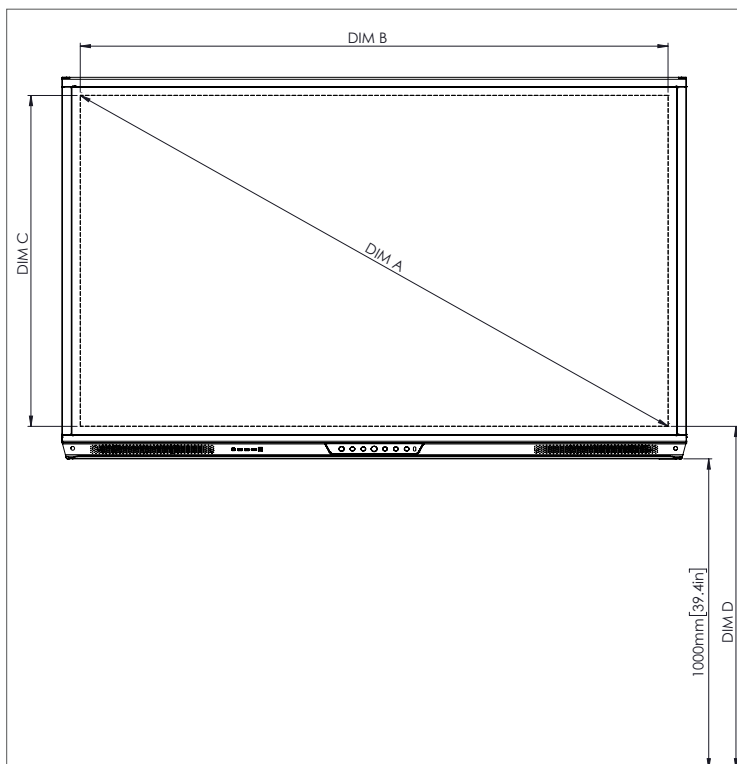

DIM	DIMENSION (MM)	DIMENSION (IN)
A	2176	85.6
B	1896	74.7
C	1067	42.0
D	1107	43.6
E	134	5.3
F	67	2.6
G	1231	48.5
H	2014	79.3
I	800	31.5
J Min	286	11.3
J Max	424	16.7
K Min	1286	50.6
K Max	1424	56.1
L	109	4.3

Back

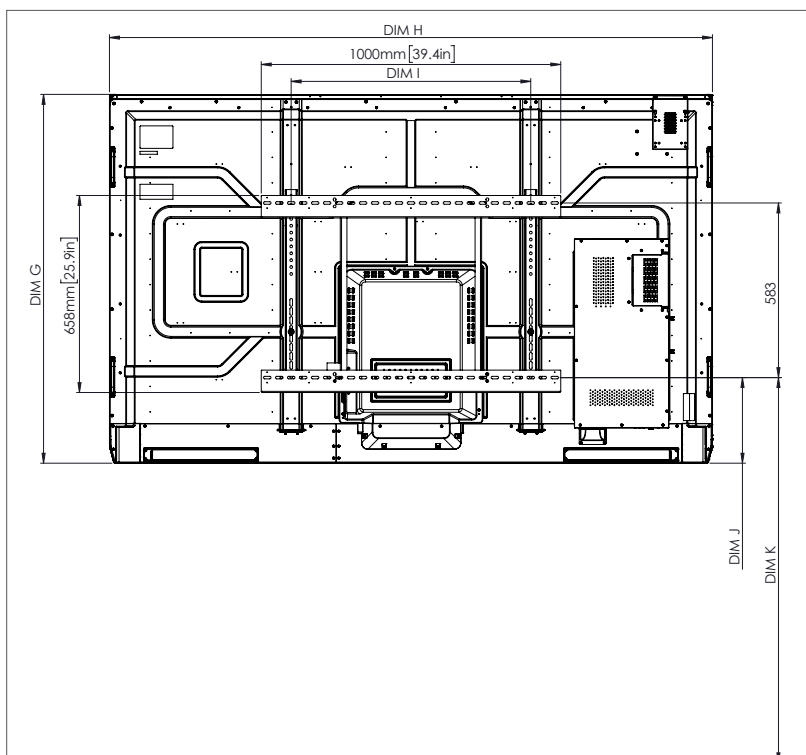

Side

